

Molded KEN-SHELTER®

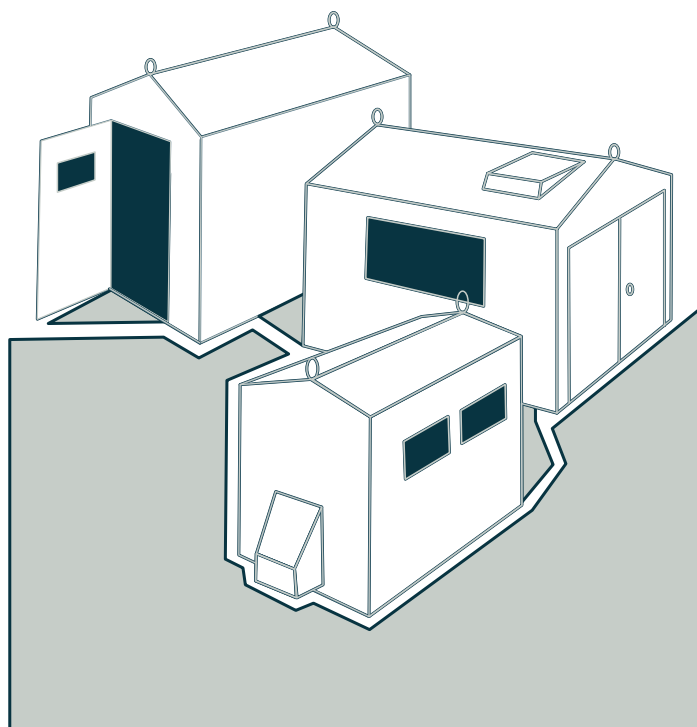

MFP

EC

ECS

Industrial Fiberglass Buildings

KEN-SHELTER® is the name to trust for your shelter needs. Since 1954 producing tough one-piece fiberglass reinforced (FRP) buildings has been a specialty of the **Kenco Plastics Company**. **KEN-SHELTER®s** are engineered to protect your equipment in the harshest natural and man-made environments. A **KEN-SHELTER®** will always be the best investment when you need to protect your equipment from nature's aggressive heat, sun, wind, snow and moisture, as well as man-made corrosive worksites.

KEN-SHELTER®s to protect:

- Pollution Monitoring Equipment
- Field Instruments
- Chlorination Equipment
- Communication Electronics
- Emergency Response Equipment
- Feed Control Systems
- Corrosive Component Storage
- Field Office
- Oil and Gas Field Test Hardware
- Safety Showers
- Water and Sanitation Pumps
- Marine Equipment



Molded KEN-SHELTER®

MFP • EC • ECS • ECSL Specifications and Reference Numbers

MFP

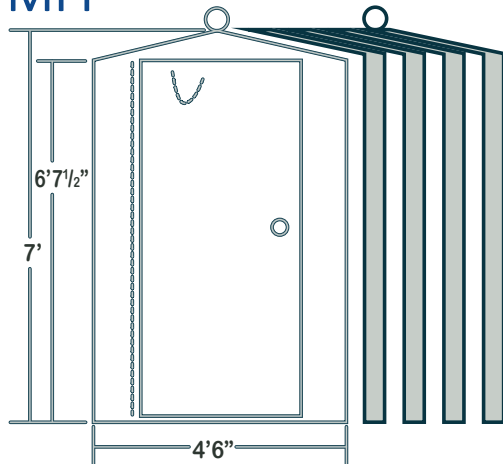

ECSL

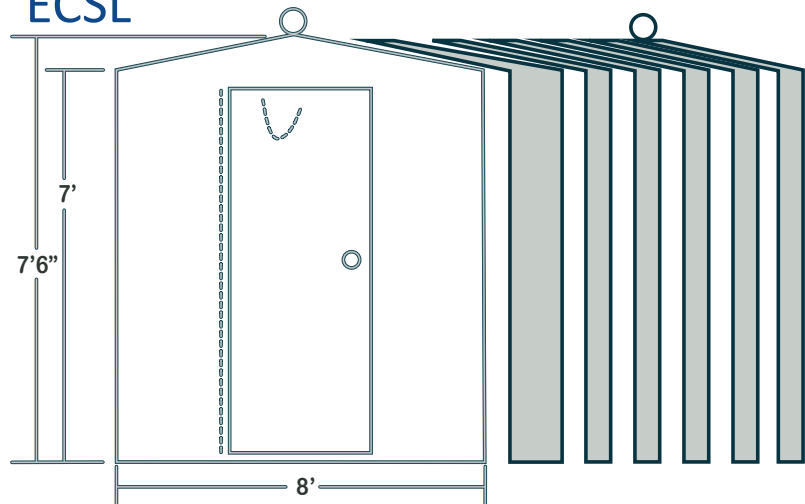

ECS

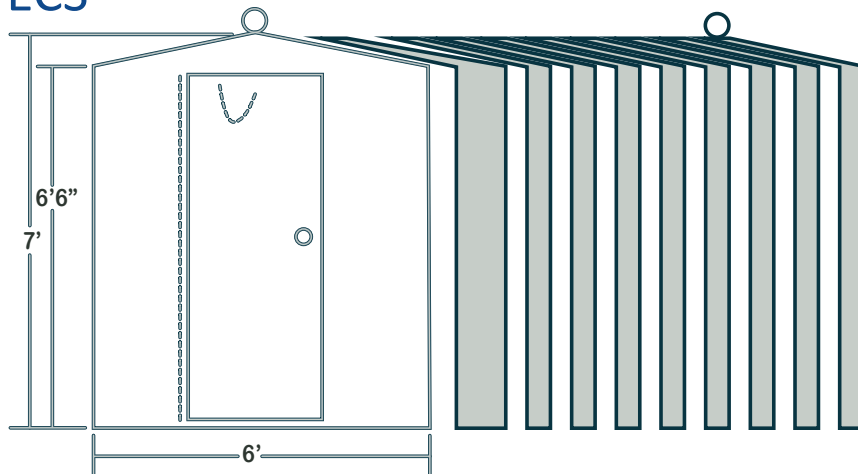

MFP

- 1' - MFP - 01
- 2' - MFP - 02
- 3' - MFP - 03
- 4' - MFP - 04

ECS

- 2' - ECS - 02
- 3' - ECS - 03
- 4' - ECS - 04
- 5' - ECS - 05
- 6' - ECS - 06
- 7' - ECS - 07
- 8' - ECS - 08
- 9' - ECS - 09
- 10' - ECS - 10

ECSL

- 5' - ECSL - 05
- 6' - ECSL - 06
- 7' - ECSL - 07
- 8' - ECSL - 08
- 9' - ECSL - 09
- 10' - ECSL - 10

EC

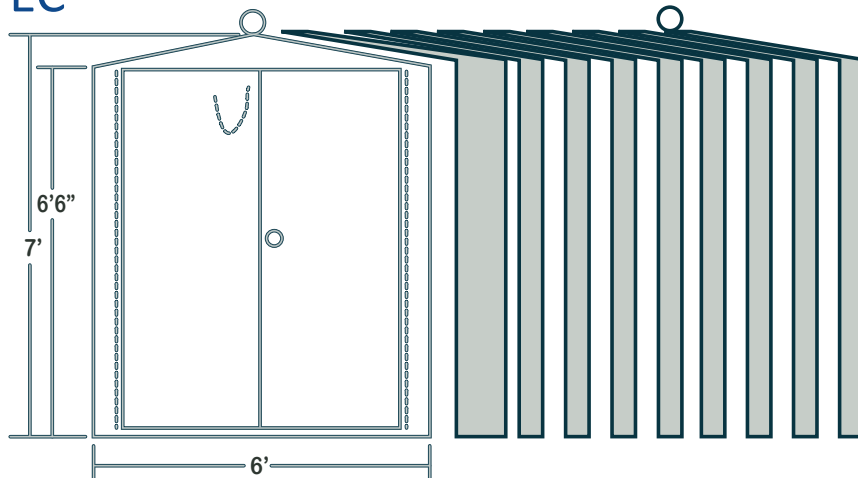

EC

- 2' - EC - 02
- 3' - EC - 03
- 4' - EC - 04
- 5' - EC - 05
- 6' - EC - 06
- 7' - EC - 07
- 8' - EC - 08
- 9' - EC - 09
- 10' - EC - 10

Molded KEN-SHELTER®

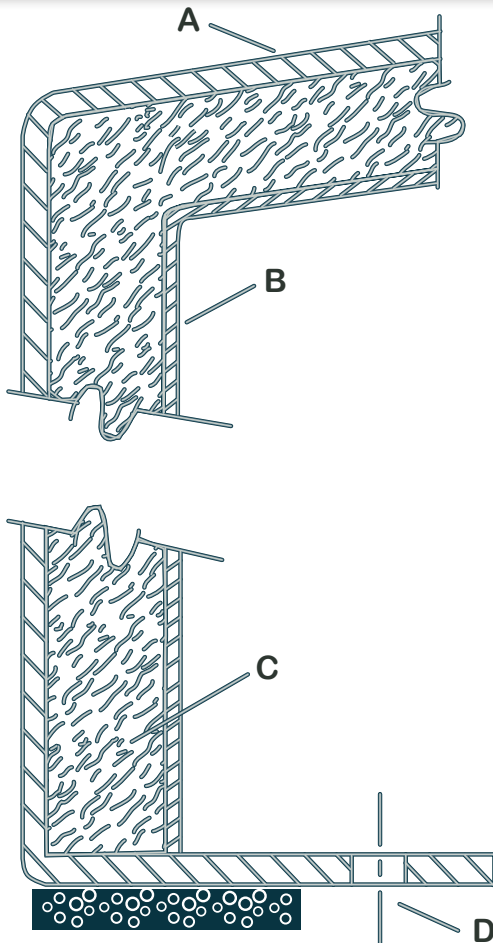

Standard Structure Features

- A** • 3/16" exterior skin of fiberglass reinforced polyester with a smooth exterior surface of isophthalic gelcoat provides a corrosion resistant and maintenance free exterior
- B** • Interior skin of 1/16" (minimum) fiberglass reinforced polyester with a quality gelcoat finish
- C** • Insulation is a 1" closed-cell polyurethane slab foam
Density = 1.6lbs/cf, K-factor=.14 BTU/hr/ft²/°F/in, R-value = 7.14/in
- D** • Base mounting is a continuous 4" wide flange that includes a 1/2" x 2" PVC perimeter sponge gasket (bolts are not included)
 - One-piece composite structure that is shipped fully assembled
 - **EC & ECS** are structurally rated for 125 MPH wind loads and 30 lbs/sq ft snow loads
 - **MFP** are structurally rated for 150 MPH wind loads and 40 lbs/sq ft snow loads
 - Two cadmium plated lifting eyes allow for easy installation (stainless steel bolts are available)
 - Standard molded-in color: white (other colors are available upon request)

Standard Door Sizes and Features

MFP: Single Door; 2'6"w x 6'3"h, O.I.C.

ECS: Single Doors available; 2'6"w, 3'0"w, or 3'6"w x 6'3"h, O.I.C.

EC: Double Door; 5'4"w x 6'3"h, O.I.C. Includes safety stop chains and cane bolt for the passive door

- A** • Fabricated laminate design: 3/16" interior and exterior FRP walls, and 1 1/2" closed-cell polyurethane slab foam insulation
- B** • Flush fitting door mounts into integrally molded door jams
- C** • Neoprene door seal gasket (weather stripping)
- D** • Continuous stainless steel piano hinge(s)
 - Neoprene door bottom wiper gasket
 - Stainless steel cylindrical lockset with keys
 - Door safety "stop" chain

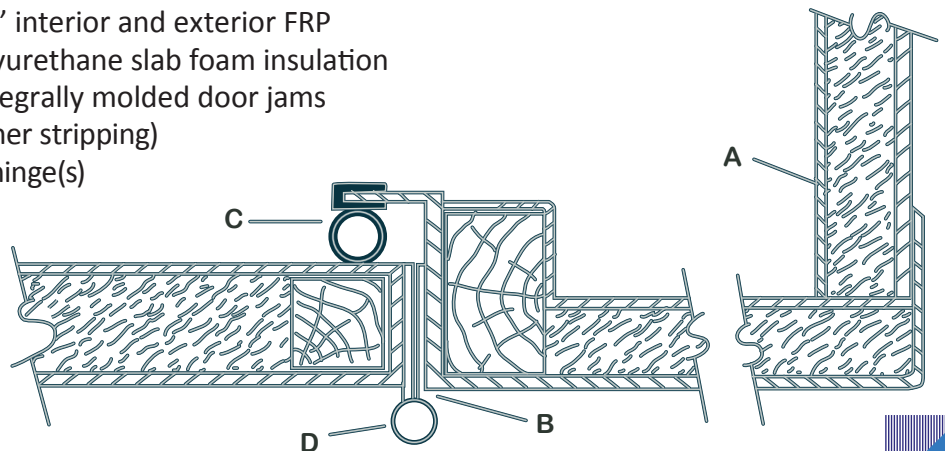

Molded KEN-SHELTER®

Custom Designs, Accessories & Options

Since **KEN-SHELTER®**s are used by so many different industries, you may not find a specific option listed below that you need. That should not be a problem. Call [Kenco Customer Service](#) today and we will provide you the engineering assistance needed to accommodate your industry specific needs. Custom programs are just a part of the outstanding customer service you can always expect at [Kenco Plastics](#).

- Building Windows: stationary 1/4" thick Lexan, sliding acrylic and special orders
- Interior partitions or walls
- Door Windows: Lexan or safety glass as required
- Thicker insulation for increased R-value
- Door activated micro switches for lights and/or fan
- Panic hardware, door closers and holders
- Explosion proof electrical equipment
- Interior and exterior duplex outlet receptacles
- Light Fixtures: incandescent and fluorescent
- Vapor tight electrical equipment
- Circuit breaker panels and fuse boxes
- Electrical wiring for all components available
- PVC or galvanized conduit
- Flooring (FRP) and shelving
- Heaters and air conditioners
- NEMA 4X components available upon request
- Exhaust fans and louvered air intake vents with screened FRP covers
- Custom colors are available

